



MSY Adriatic Paradise







Technical specifications:

Year:	1998/refit 2004
Length overall (m)	27.75m
Beam (m):	7.05m
Draft:	2.75m
Mast-head:	2x23m
Cabins:	10 double
Berths:	20
Hull material:	Mahogany
Deck material:	Teak Deck
Engine(s):	Caterpillar TD
HP:	440kw
Lying:	Marina Kastela (7km from Split airport)
Crew:	3 (Captain, Cook and Sailor)
Equipment:	showers, WC, TV, CD, Air Condition, VHF, GPS

Additional equipment:

- tender with 50 hp outboard engine
- windsurf board
- waterskiing equipment
- snorkeling and fishing equipment

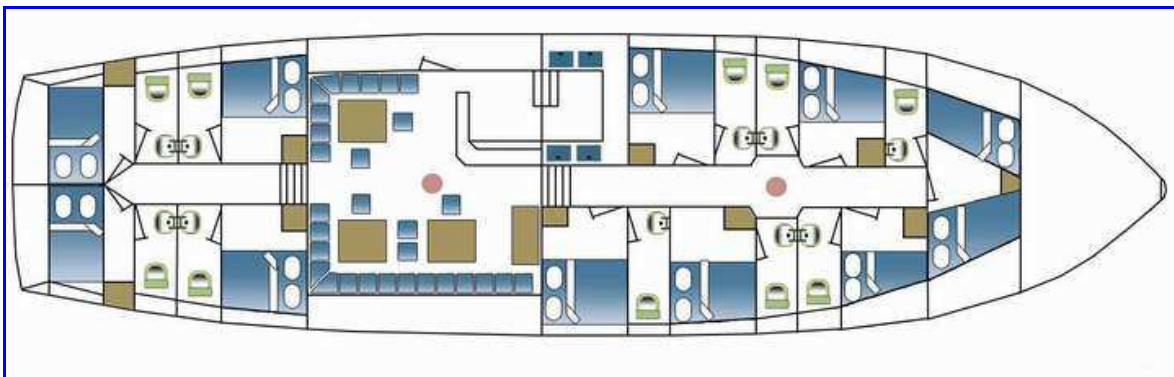

EXTRAS:

- Food (children under 12 pay 75%, children under 4 free of charge)
- Port and marina fees app. 500, 00 EUR/week (standard route)
- National parks entrance fees (if requested)
- Transfers by car/bus (if requested)
- Additional crew member (if requested: hostess 80,00 EUR/day)