



MSY gulet "JUGO"









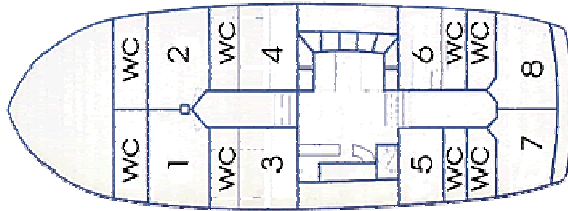

GENERAL

LOA: **28 m**
 LENGTH: **25 m**
 LWL: **21 m**
 BEAM: **6,40 m**
 DRAFT: **2,70 m**
 HIGH OVER DRAFT: **25 m**
 WEIGHT: **111 t**
 Year: **2004**
 Hull material: **mahogany 3-laminate**
 Deck material: **teak**
 Rigging: **motosailor**

EQUIPMENT

- depth sounder
- wind instruments
- compass
- VHF
- radar
- GPS
- special navigation system NAV PRO (vector charts)

DECK & SAFETY

- dinghy jockey **430**
- life raft **25 pax**
- life jackets: **28**
- fire ext: **15** and auto eng. System
- sun awning
- anchor
- chain: **150 m**
- windlass: **hydraulic**
- steering: **hydraulic**

ENGINE & MACHINERY

Type: **iveco aifo 450 hp**
 Range: **500 nm**
 Speed (engine): **8,5 cruis. – 10,5 kts max**

Speed (sailing): up to **6 kts**
Generator: **10kw ONAN**
Air condition: **reverse cycle in all spaces**
Fuel: **2000 l**
Water: **5000 l**
Waste: **5000 l**

CABINS

Guest cabin: **8 double**
Crew cabin: **1**
Toilets & Showers: **9**
Special: **-internet**
-ship mobile telephone
-kitchen with cool veg. Storage
-complet charter equipment
-windsurf,snorkeling

CREW

Crew members: **- captain**
- cook
- sailor
- optional hostess

OTHER

Other: **-create a route by yourself**
-shower on deck
-music & TV set

RATES:

30.06.-15.07	11.200, 00 EUR/week
15.07.-01.09	12.200, 00 EUR/week
May and October	7.500, 00 EUR/week
April and September	9.500, 00 EUR/week

EXTRAS:

- Food prices:
Half board (breakfast, lunch) 200, 00EUR/person/week
Full board (breakfast, lunch, dinner) 300, 00EUR/person/week
Children under 10 150, 00EUR/person/week
Children under 5 free of charge
- Drinks
domestic (if requested: consumption of all alcoholic and non alcoholic drinks) 150,00EUR/person/week
- Port and marina fees app. 600, 00EUR/week (standard route)
- National parks entrance fees (if requested)
- Transfers by car/bus (if requested)
- Additional crew member (if requested: hostess 80, 00EUR/day)

www.globecharter.com info@globecharter.com

(Croatia Zagreb office) tel./fax. +385 1 6168 55